

# Much Common, Yateley Common, commonly remembered as "the aeroplane house"

This house had a very short life, being constructed at the end of the 1930s, and was destroyed during World War II on account of the similarity of its shape to an aeroplane. Partly on account of its short life, but also because of what later happened to its plot, its precise location was for a long time a mystery.

However, it does appear on the 1939 OS map, but on a map that was difficult to obtain because it also showed the site of what became the wartime airfield. Hence we don't have any very good clean copies of this map!

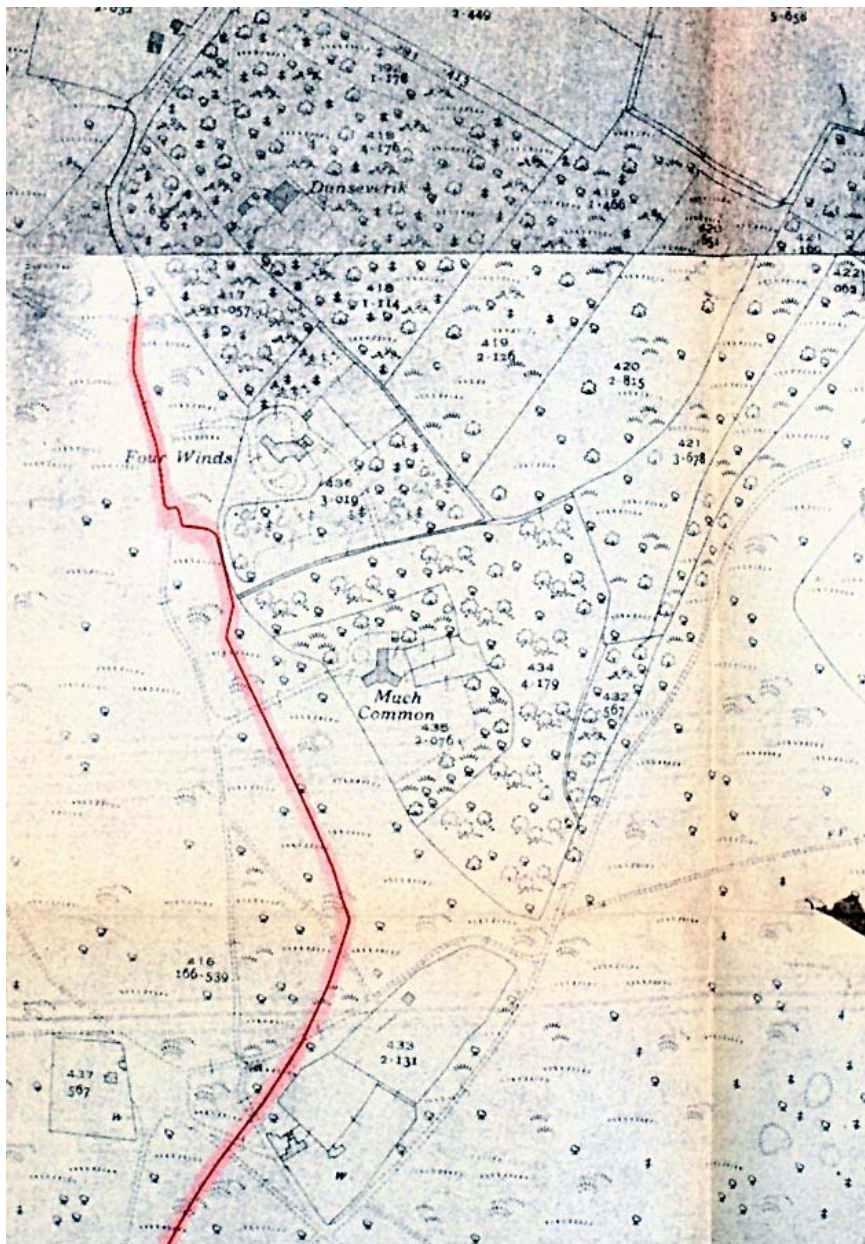

As may be seen from the map the house had a most unusual plan:

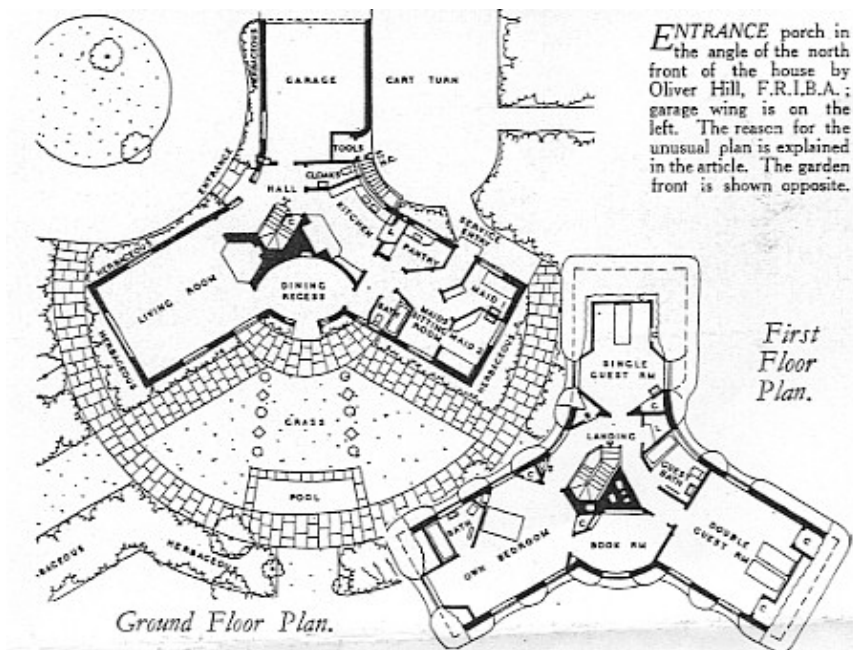

and also what was for the time a most unusual style:

February, 1939

*The Ideal Home*



PINK WALLS, CEDAR SHINGLES, NORFOLK REED

*The little house on a Hampshire common by Oliver Hill, F.R.I.B.A., described on the opposite page*



This unusual house was designed by Oliver Hill, and the *The Ideal Home* (Feb 1939 Vol XXXIX no II) described the house as follows:

## ***An UNUSUAL SHAPE***

*may be the comment on the plan of the first in the selection of three small houses given here and in the following page's of photogravure.*

*STRAIGHT lines are essential in architecture; but Oliver Hill is adept at making the lines of his cottages blend with the lines of Nature, who abhors the straight and angular as much as she is supposed to hate a vacuum. This blending will please you -- and so will the colour, though perhaps for a different reason. Lines and colour both blending with the background savours much of submergence and camouflage. So let us have a little warmth and cheer as a sign of human habitation, and express it in colour that will not make the trees cry out in agony. Some shades of pink would inflict this torture. But here is one that does not; and in choosing it for this little house Mr. Hill may have had in mind the delightful effect of some of the colour-washed cottages one used to see about the English countryside, particularly in East Anglia. The cedar shingles and shutters are left in their natural colour. They will eventually become an even more pleasant shade -- a grey tinge pervading the pink. A warm silver will steal into the brown of the Norfolk reed roof. And the chimney bricks are the colours of heather. A jolly little house among the trees in the centre of a Hampshire common! So we come to the plan. This unusual shape was devised by the architect in order that those who live in it may enjoy both sun and view in all the main rooms. The windows look across the common to the south-east and south-west. This planning has obviously helped the design of the elevation, and is responsible for the pleasant grouping and lines. E. N.*

In October 1939 the only registered elector at the house was Vere Latham Bailleu.

## **After the War**

After the war, during which time the house was demolished, the piece of land that Much Common occupied was exchanged for Common land which had been occupied by industrial buildings and is now part of the Blackbushe Business Park. It is therefore now part of Yateley Common.